

MILLER

Your System For Building Success

EDUCATIONAL FACILITIES STORAGE UNITS



OPTIMIZE OUTDOOR STORAGE

Educational Facilities Storage Units will help you organize and optimize your storage needs. These sturdy units are available in a variety of sizes and colors. They come assembled, and ready for use, to your site. They don't require foundations and can be placed on stone, asphalt, or concrete. These structures are ideal for storage of seasonal athletic equipment and other groundskeeping tools and equipment.

- All steel construction
- Standing seam roof
- Sizes up to 10' x 50'
- Peak or shed roof design
- Delivered complete
- Plywood or steel floors

MILLER

YOUR SYSTEM FOR BUILDING SUCCESS

800-323-6464 **MillerBldgs.com**

Price

Purchase experience at the best available price.
MILLER delivers excellence on-budget

Quality

Exceptional quality & reliable installation
with over 40 years of experience

Service

Your single source for design,
supply & installation

MILLER BUILDINGS, INC.

GENERAL SPECIFICATIONS Educational Facilities Storage Units

DESIGN CRITERIA: M.B.M.A. and A.I.S.I.

ROOF LOADS: Roof loads from 30 to 110 lbs. ground snow load (Snow Load Factor .7) and wind loads from 70 to 150 mph

ROOF PITCH: 1/2" in 12", up to 1" in 12"

EAVE HEIGHT: 8'4" & 9'4"

STRUCTURAL: Columns are 16" wide, 16 gauge "C" channel covered with a 26 gauge galvanized panel; factory painted with Signature 200 color coating (14 colors available.) *A 40 year limited manufacturer's paint warranty.* Headers are 26 gauge factory painted panels matching the color and profile of the roll-up doors. Posts and purlins are 16 gauge.

EXTERIOR FRAMED OPENINGS: 8'8" and 3'8" wide by 7'0" high. Dummy door panels or "R" panel factory painted sheeting will be used at the corners of the building.

ROOF: 24 gauge bare Galvalume Plus Standing Seam with a fixed clip system. *20 year manufacturer's warranty.* Gutters and downspouts (or false gutters) are available as an option. Insulation: Ply-Foil Bubble.

FLOOR SYSTEM: Three layer system combining pressure-treated lumber and galvanized metal, within a frame of 16 gauge steel. The subfloor is constructed of pressure-treated 2x4's laid flat and topped by 2x4 floor joists on 16" centers. The interior flooring system is made up of 3/4" Performax plywood. The entire perimeter of the floor is then framed in 16 gauge steel which forms a 3/4" raised lip to keep water out.

ANCHOR SYSTEM: All four corners have a bracket assembly that will be bolted to a ground rod, which we supply.

WALL PANELS: 26 gauge Galvalume Plus "R" panel with Signature 200 color coating (14 colors available.) *40 year manufacturer's paint warranty.*

PARTITIONS: 29 gauge Galvalume Plus "U" panels, used as unit dividers.

DOORS: Roll-up doors are 26 gauge pre-painted galvanized steel complete with coil springs, brackets, door stops, slide latch and bottom bar with rubber astragal. (23 colors available.) *40 year manufacturer's limited paint warranty.*

OPTIONS:

- All Galvanized Structural Material
- Flush Door Jambs and Headers
- Galvanized Structural Door Jambs
- Vinyl-Backed Fiberglass Insulation
- Gutters and Downspouts
- Storage Master Locks
- Metal Floor System

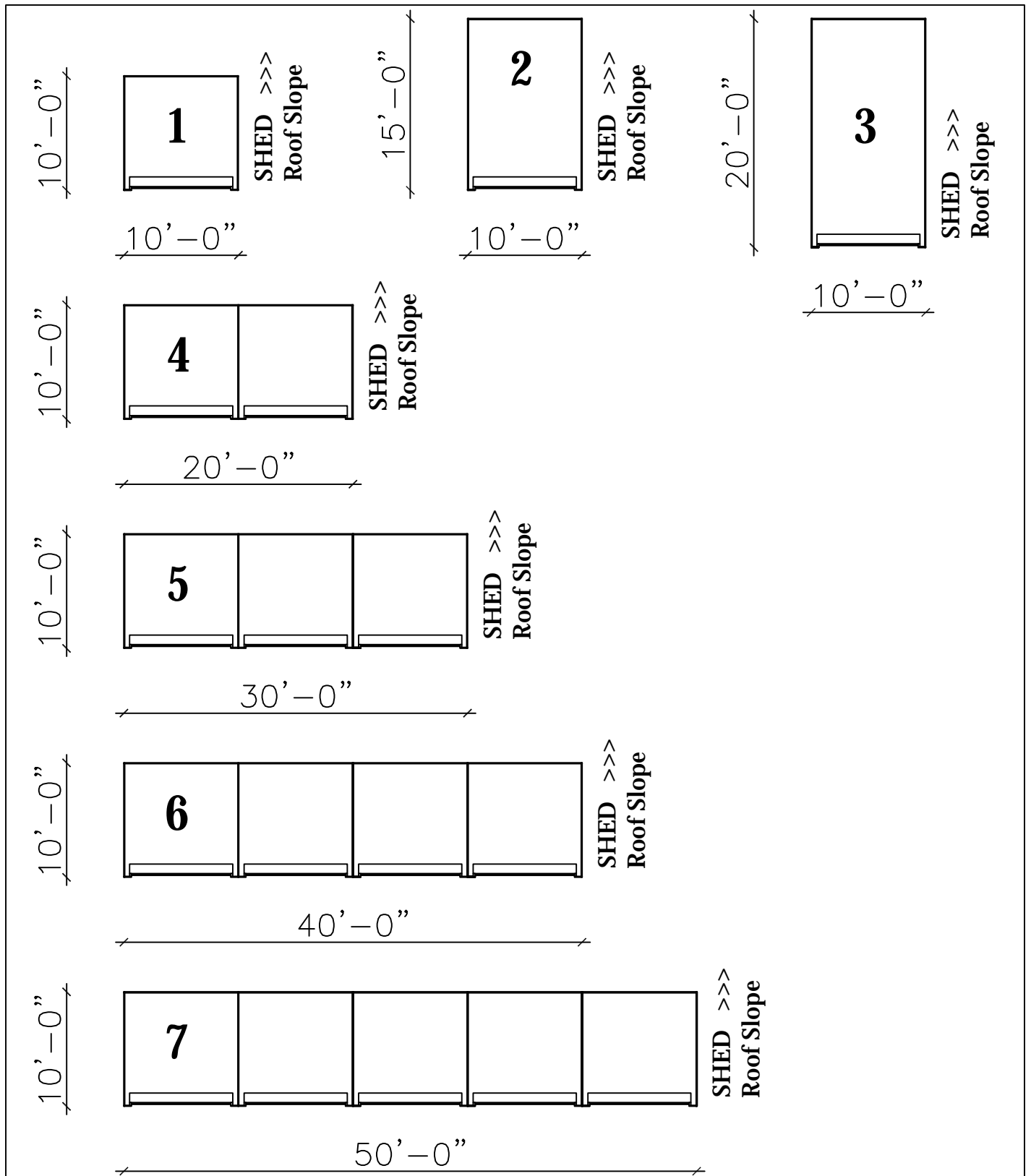

Date	11-11-19	Job Description		MILLER BUILDING SYSTEMS	<table border="1"> <tr><td></td><td></td><td></td><td></td><td></td><td></td></tr> <tr><td></td><td></td><td></td><td></td><td></td><td></td></tr> <tr><td></td><td></td><td></td><td></td><td></td><td></td></tr> <tr><td></td><td></td><td></td><td></td><td></td><td></td></tr> <tr><td></td><td></td><td></td><td></td><td></td><td></td></tr> <tr><td></td><td></td><td></td><td></td><td></td><td></td></tr> <tr><td></td><td></td><td></td><td></td><td></td><td></td></tr> <tr><td></td><td></td><td></td><td></td><td></td><td></td></tr> <tr><td></td><td></td><td></td><td></td><td></td><td></td></tr> <tr><td></td><td></td><td></td><td></td><td></td><td></td></tr> </table>																																																												
Drawn By	psf	Pa. Educational Facilities	<p>These drawings have been prepared for buildings incorporating methods & materials utilized by Miller Building Inc.</p> <p>Any unauthorized use of this drawings in whole or in part is prohibited and this notice shall serve to hold harmless Miller Building Inc.,</p>																																																														
Scale		Storage Units																																																															
Order No.																																																																	
Sheet No.		Sheet Title	Relocatable	Date	Revision	By																																																											